

RESOLUTION NO. 1161

A RESOLUTION authorizing dedication of certain City real property to the construction of Northwest Leadbetter Drive.

WHEREAS, the City of Camas is the owner of certain real property situate in Clark County, Washington, more particularly described in Exhibits "A" and "B" attached hereto and by this reference incorporated herein; and

WHEREAS, said real property constitutes a portion of property otherwise utilized for open space purposes; and

WHEREAS, construction of Northwest Leadbetter Drive will improve access within and about the Grass Valley area and further provide improved access and safety for pedestrians and student traffic to and from Skyridge Middle School and Grass Valley Elementary School; and

WHEREAS, dedication of the real property described in Exhibit "A" is necessary for the construction of the improvements at Northwest Leadbetter Drive as signified in the Camas Capital Facilities Plan.

NOW, THEREFORE, BE IT RESOLVED BY THE COUNCIL OF THE CITY OF CAMAS AS FOLLOWS:

SECTION I

The real property in Exhibits "A" and "B" shall hereby be dedicated exclusively for the right-of-way area for the Northwest Leadbetter construction project.

SECTION II

ADOPTED at a regular Council meeting this 17th day of August, 2009.

SIGNED: 
Mayor

ATTEST: 
Clerk

APPROVED as to form:

City Attorney

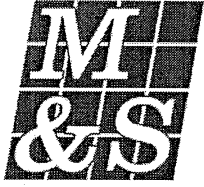

MacKay & Sposito, Inc. www.mackaysposito.com

MacKay & Sposito, Inc.
1325 SE Tech Center Drive, Suite 140
Vancouver, WA 98683
Phone: 360-695-3411
Fax: 360-695-0833

14385LD4
5/27/09
btm

EXHIBIT "A"

LEGAL DESCRIPTION
RIGHT OF WAY ACQUISITION-NW LEADBETTER DRIVE
PORTION OF CITY OF CAMAS PARCEL
CITY OF CAMAS, WASHINGTON

Real property situated in the City of Camas, Clark County, Washington, being a portion of that tract of land conveyed to the City of Camas by deed recorded under Auditor's File No. 9703280299, records of said county and lying in the Northwest quarter of Section 33, Township 2 North, Range 3 East of the Willamette Meridian, described as follows:

Beginning at the Northwest corner of Lacamas Meadows P.R.D., according to the plat thereof, recorded in Book 311 of plats, at Page 422, said corner being the Northeast corner of said City of Camas tract; thence along the West line of said plat and the East line of said City of Camas tract South 01° 12' 14" West 30.00 feet; thence leaving said West and East lines North 88° 39' 53" West 461.01 feet to a point of curvature with a 530.00 foot radius curve; thence along said curve to the right, through a central angle of 19° 22' 12", an arc distance of 179.18 feet to the North line of said City of Camas tract as set by that Boundary Adjustment Agreement recorded under Auditor's File No. 8910120163; thence along the North line of said City of Camas tract South 88° 39' 53" East 636.73 feet to the **Point of Beginning**.

Containing approximately 17,370 square feet or 0.399 acres.

Subject to easements and restrictions of record.

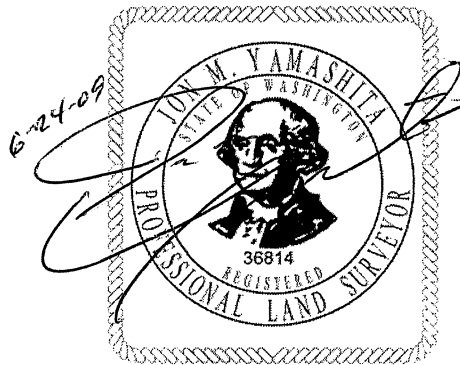

SKETCH TO ACCOMPANY LEGAL DESCRIPTION
 RIGHT OF WAY ACQUISITION-NW LEADBETTER DRIVE
 PORTION OF CITY OF CAMAS PARCEL
 CITY OF CAMAS, WASHINGTON

SCALE: 1"=100'
 JUNE, 2009

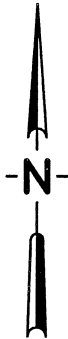
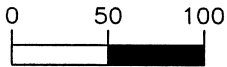

CAMAS SCHOOL DISTRICT #117
 AF# 9503310349

UNDERWRITER'S
 LABORATORIES, INC.

BOUNDARY LINE ADJUSTMENT
 AF# 8910120163

PROPOSED NW LEADBETTER DRIVE

S88°39'53"E 636.73'

POINT OF
 BEGINNING

NW
 LEADBETTER
 DRIVE

S01°12'14"W 30.00'

$\Delta=19^{\circ}22'12''$
 $R=530.00'$
 $L=179.18'$

N88°39'53"W

461.01'

42	41	40	39	38
----	----	----	----	----

CITY OF CAMAS
 PARCEL 1
 AF# 9703280299

LACAMAS MEADOWS
 BOOK 311, PAGE 422

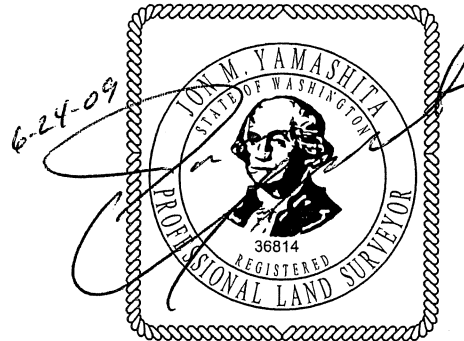

MacKay & Sposito, Inc. 
 ENGINEERS SURVEYORS PLANNERS
 VANCOUVER, WASHINGTON KENNEWICK, WASHINGTON