



**NOTICE OF APPLICATION FOR SHORELINE SUBSTANTIAL DEVELOPMENT
PERMIT and SHORELINE VARIANCE FOR HUBBARD DOCK
(File #SHOR18-01)**

The city received an application from Brant Hubbard for a Shoreline Substantial Development Permit and Shoreline Variance to construct a private dock on March 7, 2018. The proposed dock will be located at 1180 SE Polk Street, on the Columbia River. The project will require a variance due to the need for 12-inch pilings, which are the typical size for dock construction in the river.

Application Materials: The application was technically complete on April 27, 2018 and included the following documents, which are available for review at the Community Development Department (616 NE 4th Avenue): Narrative; Site drawings; Biological Evaluation; Joint Aquatic Resources Permit Application (JARPA) and State Environmental Policy Act Checklist (SEPA).

Comment Deadline: Written comments must be received in the next 30 days, by **June 4, 2018**, before 5:00 p.m. Mailed comments may be directed to the Community Development Department, c/o Shoreline Administrator, 616 NE Fourth Avenue, Camas, WA 98607, or email your comments to communitydevelopment@cityofcamas.us. Only those persons who respond in writing (**indicating interest in the project**) will be included in future mailings, and receive a copy of the final decision.

Public Meeting: The application will be considered for approval by the Shoreline Management Review Committee at a public meeting on **June 7, 2018 at 4:00 p.m.** (or shortly thereafter). The meeting will be held at Camas City Hall, 616 NE 4th Avenue, Camas, 98607.

For questions related to this application, please contact Sarah Fox, Senior Planner, at (360) 817-7269 or communitydevelopment@cityofcamas.us.

PROPOSED HUBBARD DOCK SITE PLAN

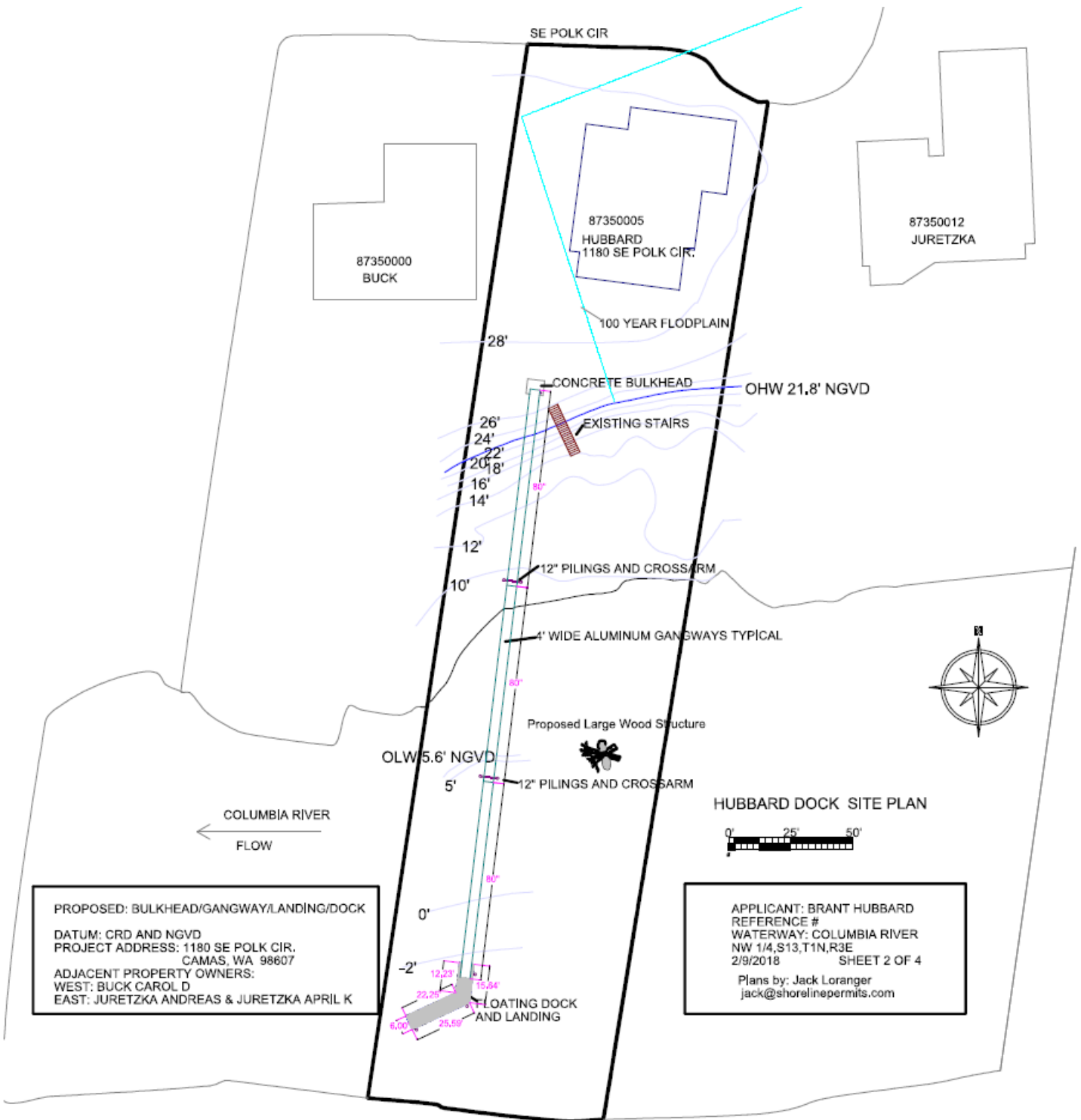

PROPOSED: BULKHEAD/GANGWAY/LANDING/DOCK
 DATUM: CRD AND NGVD
 PROJECT ADDRESS: 1180 SE POLK CIR.
 CAMAS, WA 98607
 ADJACENT PROPERTY OWNERS:
 WEST: BUCK CAROL D
 EAST: JURETZKA ANDREAS & JURETZKA APRIL K

HUBBARD DOCK SITE PLAN
 0' 25' 50'
 APPLICANT: BRANT HUBBARD
 REFERENCE #
 WATERWAY: COLUMBIA RIVER
 NW 1/4, S13, T1N, R3E
 2/9/2018 SHEET 2 OF 4
 Plans by: Jack Loranger
 jack@shorelinepermits.com